

QPOFY-XXS1-X-024

Number of Contacts | Pin Length mm

No. of Contacts	DIMENSIONS		REMARK (備註)
	A	B	
2	1.27	2.88	○
3	2.54	4.15	○
4	3.81	5.42	○
5	5.08	6.69	○
6	6.35	7.96	○
7	7.62	9.23	○
8	8.89	10.50	○
9	10.16	11.77	○
10	11.43	13.04	○
11	12.70	14.31	○
12	13.97	15.58	○
13	15.24	16.85	○
14	16.51	18.12	○
15	17.78	19.39	○
16	19.05	20.66	○
17	20.32	21.93	○
18	21.59	23.20	○
19	22.86	24.47	○
20	24.13	25.74	○
21	25.40	27.01	○
22	26.67	28.28	○
23	27.94	29.55	○
24	29.21	30.82	○
25	30.48	32.09	○
26	31.75	33.36	○
27	33.02	34.63	○
28	34.29	35.90	○
29	35.56	37.17	○
30	36.83	38.44	○
31	38.10	39.71	○
32	39.37	40.98	○
33	40.64	42.25	○
34	41.91	43.52	○
35	43.18	44.79	○
36	44.45	46.06	○
37	45.72	47.33	○
38	46.99	48.60	○
39	48.26	49.87	○
40	49.53	51.14	○

SPECIFICATIONS

Current Rating: 1 Amp
 Insulator resistance: 5000 Megohms min.
 Contacts resistance: 20 m ohms max.
 Dielectric withstanding: AC 500 V
 Operating Temperature: -40°~+105°C
 Max Processing Temp: 230° for 30 seconds
 Contact Material: Phosphor bronze
 Insulator Material: High Temperature Thermoplastic, UL B4V-D
 Color: Black

Contact Plating

Definition	Code
◎ Tin plated:	A
◎ Gold plated:	
Flash B	15μ* F
10μ* E	30μ* J
◎ Duplex plating:	
Flash K	15μ* P
10μ* N	30μ* U
◎ Standard: B	
◎ Prefix "V" means lead free plating.	

Finish: Gold plated
 ◎ Standard: Gold flash all over
 ◎ Note: Duplex plating: gold plated on contact area, Tin on solder area

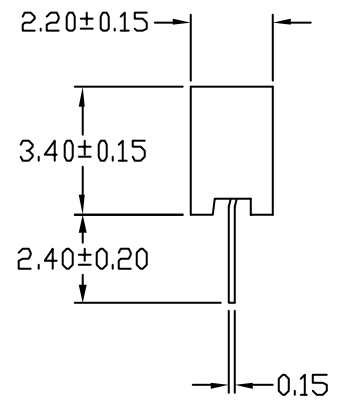
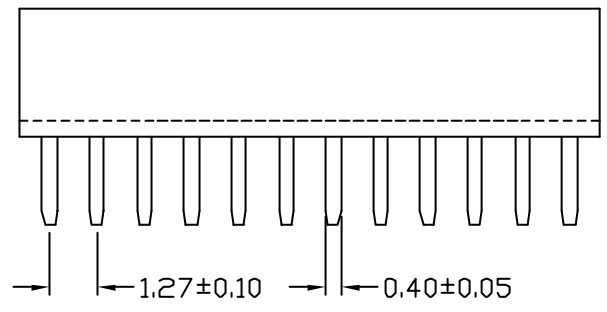
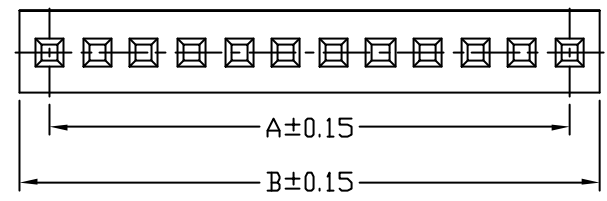

Recommended PCB Layout
 (PCB TOLERANCE ±0.05)

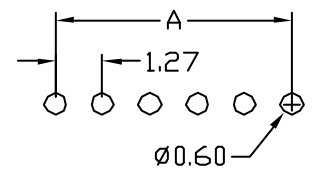

Rev.	ECN Number	Description	Drawn	Date
2	DOC9211024	圖面改版	王佩云	13/11/03'
3	DOC9212241	圖面修改 4.30改3.40	王佩云	16/12/03'
4	EC3-520022	新增2PIN	陳顯奎	02/23 05'



GENERAL TOLERANCE		SCALE
XX. ± 0.50	XXX. ±	1=1
X. ± 0.30	.XXX ±	UNIT MM
.X ± 0.25	.X* ± 4°	SIZE A4/X
.XX ± 0.20	.X* ± 4°	

ORIGINAL DRAWN	DATE
江坤容	26-09-01'
CHECK	DATE
江坤容	02/23 05'
APPROVE	DATE
林錫錦	02/23 05'

DWG. NO.	TITLE	REV.
1-10	1.27mm SOCKET	4
F:\DWG\CDWG\QPOFY\QPOFYSOC.DWG	(成品規格圖)	SHEET 1/1
PARTS NO. QPOFY-XXS1-X-024		