

No. of Contacts	DIMENSIONS		REMARK (備註)
	A	B	
2	2.54	5.88	○
3	5.08	8.42	○
4	7.62	10.96	○
5	10.16	13.50	○
6	12.70	16.04	○
7	15.24	18.58	○
8	17.78	21.12	○
9	20.32	23.66	○
10	22.86	26.20	○
11	25.40	28.74	○
12	27.94	31.28	○
13	30.48	33.82	○
14	33.02	36.36	○
15	35.56	38.90	○
16	38.10	41.44	○
17	40.64	43.98	○
18	43.18	46.52	○
19	45.72	49.06	○
20	48.26	51.60	○
21	50.80	54.14	○
22	53.34	56.68	○
23	55.88	59.22	○
24	58.42	61.76	○
25	60.96	64.30	○
26	63.50	66.84	○
27	66.04	69.38	○
28	68.58	71.92	○
29	71.12	74.46	○
30	73.66	77.00	○
31	76.20	79.54	○
32	78.74	82.08	○
33	81.28	84.62	○
34	83.82	87.16	○
35	86.36	89.70	○
36	88.90	92.24	○
37	91.44	94.78	○
38	93.98	97.32	○
39	96.52	99.86	○
40	99.06	102.40	○

PWFY-XXS-X-035
 Number of Contacts
 Straight

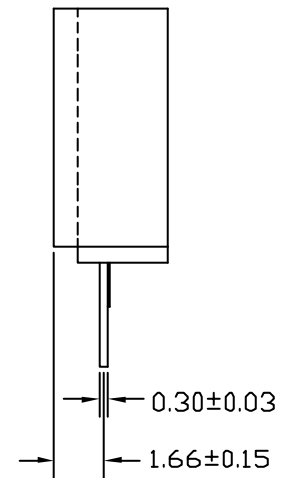
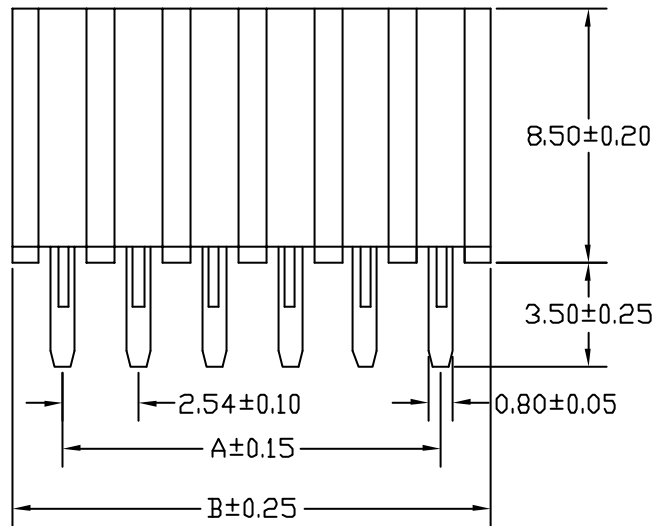
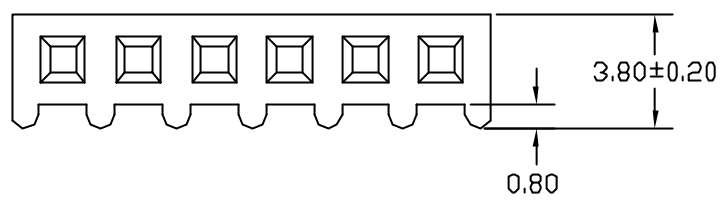

Contact Plating

Definition	Code
◎ Tin plated:	A
◎ Gold plated:	
flash B 15μ"	F
10μ" E 30μ"	J
◎ Duplex plating:	
flash K 15μ"	P
10μ" N 30μ"	U
◎ Standard: B	
◎ Prefix "V" means lead free plating.	

SPECIFICATIONS

Current Rating: 3 Amps
 Insulator resistance: 5000 Megohms min.
 Contact resistance: 20 m ohms max.
 Dielectric withstanding: AC 1000 V
 Operating Temperature: -40°~+105°C
 Contact Material: Phosphor bronze
 Insulator Material: Polyester, UL 94V-0
 ◎Standard: P.B.T
 Finish: Tin, Gold or Duplex plated
 ◎Standard: Gold flash all over
 ◎Note: Duplex plating: gold plated on contact area, Tin on solder area

Recommended PCB Layout
 (PCB TOLERANCE ±0.05)

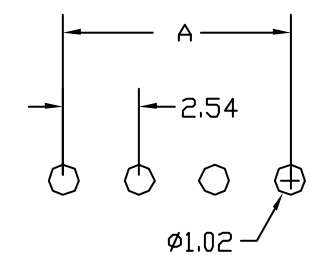

Rev.	ECN Number	Description	Drawn	Date
2	ECR-530103	圖面新增2PIN	陳顯鑫	03/30 05'



GENERAL TOLERANCE		SCALE
XX. ± 0.50	XXX. ±	4=1
X. ± 0.30	.XXX ±	UNIT MM
.X ± 0.25	.X. ± 4°	SIZE A4/X
.XX ± 0.20	.X. ± 4°	

ORIGINAL DRAWN	DATE
黃建慶	07/17 01'
CHECK	DATE
江坤容	03/30 05'
APPROVE	DATE
林錫錫	03/30 05'

DWG. NO.	TITLE	REV.
I-X-XX	成品規格圖	2
F:\DWG\CDWG\PWF\PWFYS0A.DWG		SHEET 1/1
PARTS NO. PWFY-XXS-X-035		