

CIRCUITS	DIM A	DIM B	DIM C	DIM D	W/O Locating Peg	With Locating Peg
6	1.00	3.50	2.70	2.50	⊕	⊕
10	2.00	4.50	3.70	3.50	⊕	
12	2.50	5.00	4.20	4.00		
14	3.00	5.50	4.70	4.50		
16	3.50	6.00	5.20	5.00		
18	4.00	6.50	5.70	5.50		
20	4.50	7.00	6.20	6.00	⊕	△
22	5.00	7.50	6.70	6.50		
24	5.50	8.00	7.20	7.00	⊕	⊕
26	6.00	8.50	7.70	7.50		
28	6.50	9.00	8.20	8.00	⊕	
30	7.00	9.50	8.70	8.50	⊕	
32	7.50	10.00	9.20	9.00		
34	8.00	10.50	9.70	9.50	⊕	
36	8.50	11.00	10.20	10.00		
38	9.00	11.50	10.70	10.50		
40	9.50	12.00	11.20	11.00	⊕	⊕
42	10.00	12.50	11.70	11.50		
44	10.50	13.00	12.20	12.00		
46	11.00	13.50	12.70	12.50		
48	11.50	14.00	13.20	13.00		
50	12.00	14.50	13.70	13.50	⊕	
52	12.50	15.00	14.20	14.00		
54	13.00	15.50	14.70	14.50		
56	13.50	16.00	15.20	15.00		
58	14.00	16.50	15.70	15.50		
60	14.50	17.00	16.20	16.00	⊕	
70	17.00	19.50	18.70	18.50		
80	19.50	22.00	21.20	21.00		
AO(100)	24.50	27.00	26.20	26.00	⊕	

Rev.	ECN Number	Description	Drawn	APPD.
14	ECR-510047	取消 06PIN有導量產	陳美竹	林錫銘 12/28 04
15	EC3-530002	新增40PIN無導量產模	陳顯鑫	林錫銘 01/29 05
16	EH07100017	20Pin(DimB)尺寸由10.0改為7.00	Ken Deng	Liss Xiang 10/11/07

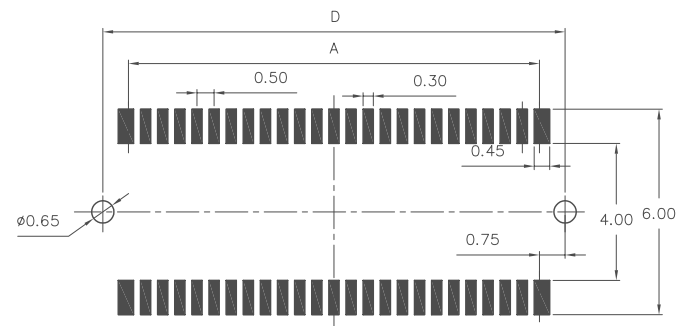

NOTES: (UNLESS OTHERWISE SPECIFIED)

- CURRENT RATING: 0.3 AMPERE.
- CONTACT RESISTANCE: 60 m ohms MAX. FOR INITIAL.
- DIELECTRIC WITHSTANDING: AC 50V
- INSULATION RESISTANCE: 100 M ohms MIN..
- HARMFUL MATERIAL SHOULD BE COMPLIANT TO DOC. "EI-0005" STANDARDS.
- PRODUCT NUMBER MATRIX:

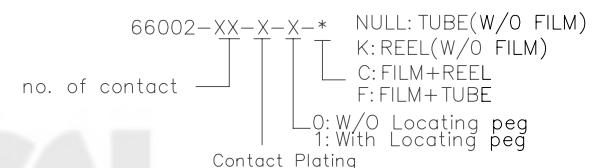

Definition	Code
◎ Tin plated:	A
◎ Gold plated:	
flash B 15μ"	F
10μ" E 30μ"	J
◎Duplex plating:	
flash K 15μ"	P
10μ" N 30μ"	U
◎Standard: B	
◎Prefix "V" means lead free plating	

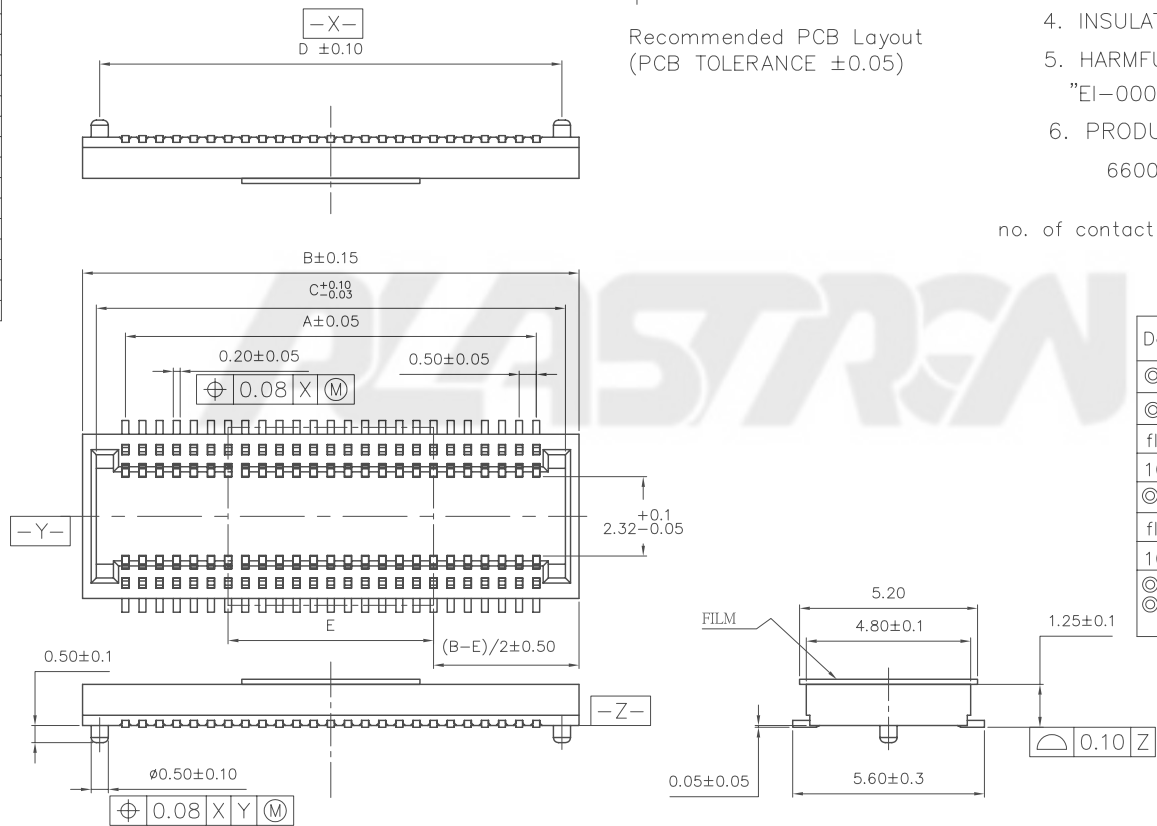

Diagram	Molding description
○	mass production & assemble mold
◎	sample & assemble mold
⊕	mass production & fix mold
⊕	sample & fix mold

PIN數	FILM(E)
6PIN	3.0X5.2
18PIN(含)以下	Ø4.0
18PIN以上	6.0X5.2



GENERAL TOLERANCE		SCALE	ORIGINAL DRAWN	DATE	DWG. NO.	TITLE	REV.
XX. ± 0.40	XXX. ±	N/A	Song	04/07/04'	600-0000-0390	CUSTOMER DRAWING	16
X. ± 0.25	.XXX ±	UNIT	CHECK	DATE			REVISION
.X ± 0.15	X.° ± 3°	MM			PARTS NO.(INTENDED USE)	0.5mm Board To Board	SHEET
.XX ± 0.10	.X° ± 2°	SIZE	APPROVE	DATE	66002-XX-X-X-*	Socket Series	1/1