

No. of Contacts	DIMENSIONS		REMARK (備註)
	A	B	
4	2.00	4.00	○
6	4.00	6.00	○
8	6.00	8.00	○
10	8.00	10.00	○
12	10.00	12.00	○
14	12.00	14.00	○
16	14.00	16.00	○
18	16.00	18.00	○
20	18.00	20.00	○
22	20.00	22.00	○
24	22.00	24.00	○
26	24.00	26.00	○
28	26.00	28.00	○
30	28.00	30.00	○
32	30.00	32.00	○
34	32.00	34.00	○
36	34.00	36.00	○
38	36.00	38.00	○
40	38.00	40.00	○
42	40.00	42.00	○
44	42.00	44.00	○
46	44.00	46.00	○
48	46.00	48.00	○
50	48.00	50.00	○
52	50.00	52.00	○
54	52.00	54.00	○
56	54.00	56.00	○
58	56.00	58.00	○
60	58.00	60.00	○
62	60.00	62.00	○
64	62.00	64.00	○
66	64.00	66.00	○
68	66.00	68.00	○
70	68.00	70.00	○
72	70.00	72.00	○
74	72.00	74.00	○
76	74.00	76.00	○
78	76.00	78.00	○
80	78.00	80.00	○

©For illustration purpose the XTT-XXS1-X-055/028 was shown

Recommended PCB Layout
(PCB TOLERANCE ±0.08)

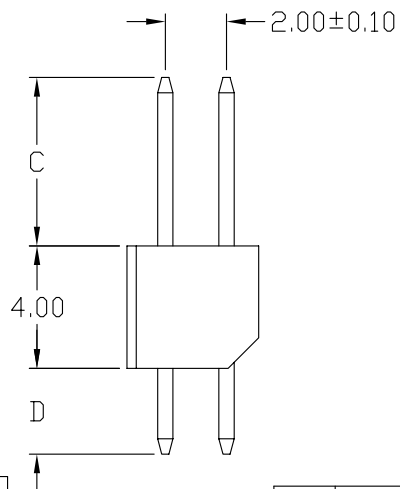
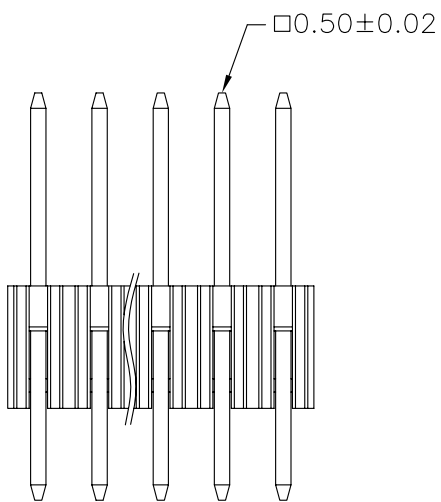
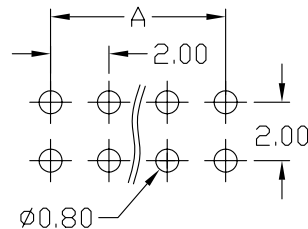
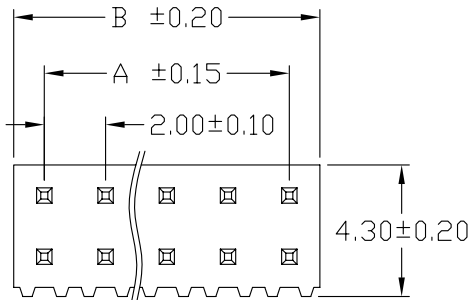

SPECIFICATIONS

Current Rating: 1 Amp
 Insulator resistance: 5000 Megohms min.
 Dielectric withstanding: AC 500 V
 Operating Temperature: -40° - +105°C
 Contact Material: Copper Alloy
 Insulator Material: High Temperature Thermoplastic, UL 94V-0
 Color : Black

Finish: Tin, Gold or Duplex plated
 ◎ Standard: Duplex plated
 ◎ Note: Duplex plating: gold plated on contact area, Tin on solder area

Pin type		Contact Plating	
Brass	L	Definition	Code
Brass (Reel)	B	◎ Tin plated:	A
Phosphor Bronze	P	◎ Gold plated:	
◎ Standard: L		flash	B 15μ" F
		10μ"	E 30μ" J
		◎ Duplex plating:	
		flash	K 15μ" P
		10μ"	N 30μ" U
		◎ Standard: B	
		◎ Prefix "V" means lead free plating.	

Diagram	Molding description
○	mass production & assemble mold
◎	sample & assemble mold
⊕	mass production & fix mold
⊕	sample & fix mold

Rev.	ECN Number	Description	Drawn	Date
2	EC2-470306	新增電鍍選項	洪銀雯	07/19/04'
3	EC2-4B0324	新增針長028/028	邱若婷	11/17 04'
4	EC3-620072	新增 PTT-XXS1-X-070/028	詹益東	02/21 06'



GENERAL TOLERANCE		SCALE	1=1	ORIGINAL DRAWN	邱若婷	DATE	03'/07/31
XX. ± 0.50	XXX. ±	UNIT	MM	CHECK	林錫錦	DATE	02/21 06'
X. ± 0.30	.XXX ±	SIZE	A4/4	APPROVE	林錫錦	DATE	02/21 06'
.X ± 0.25	X.° ± 4°						
.XX ± 0.20	.X° ± 4°						

DWG. NO.	2-19	TITLE	REV.
F:\DWG\CDWG\TT\TTSOR.DWG		2.0X2.0mm HEADER	4
PARTS NO.		(成品規格圖)	SHEET
XTT-XXS1-X-C/D			1/2