

No. of Contacts	DIMENSIONS		PBT	
	A	B	無鼻子	有鼻子
6	5.08	12.62	○	⊕
8	7.62	15.16	○	⊕
10	10.16	17.70	○	⊕
14	15.24	22.78	○	⊕
16	17.78	25.32	○	⊕
20	22.86	30.40	○	⊕
24	27.94	35.48	○	⊕
26	30.48	38.02	○	⊕
28	33.02	40.56	○	⊕
30	35.56	43.10	○	⊕
32	38.10	45.64	○	⊕
34	40.64	48.18	○	⊕
36	43.18	50.72	○	⊕
40	48.26	55.80	○	⊕
44	53.34	60.88	○	⊕
48	58.42	65.96	○	⊕
50	60.96	68.50	○	⊕
52	63.50	71.04	○	⊕
60	73.66	81.20	○	⊕
64	78.74	86.28	○	⊕

PARTS NO.	C	REMARK (備註)
BPHFZ-XXR-X-032-X-*	3.20	○
BPHFZ-XXR-X-050-X-*	5.00	○

BPHFZ-XXR-X-C-X-*

Number of Contacts: []
 Angle: []

Pin Length mm: []

Contact Plating:

0:W/O Polarization Bump
 1:With Polarization Bump

NULL: Thermoplastic
 F: High Temperature

Definition	Code
◎ Tin plated:	A
◎ Gold plated:	
flash B 15μ"	F
10μ" E 30μ"	J
◎ Duplex plating:	
flash K 15μ"	P
10μ" N 30μ"	U
◎ Standard:	B
◎ Prefix "V" means lead free plating	

SPECIFICATIONS

Current Rating: 3 Amps
 Insulator resistance: 5000 Megohms min.
 Contact resistance: 20 m ohms max.
 Dielectric withstanding: AC 1000 V
 Operating Temperature: -40°~+105°C
 Contact Material: Phosphor bronze
 Insulator Material: Polyester, UL 94V-0
 ◎ Standard: P.B.T

Finish: Tin, Gold or Duplex plated
 ◎ Standard: Gold flash all over
 ◎ Note:
 Duplex plating: gold plated on contact area, Tin on solder area

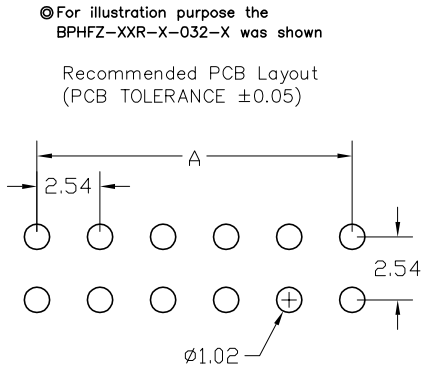
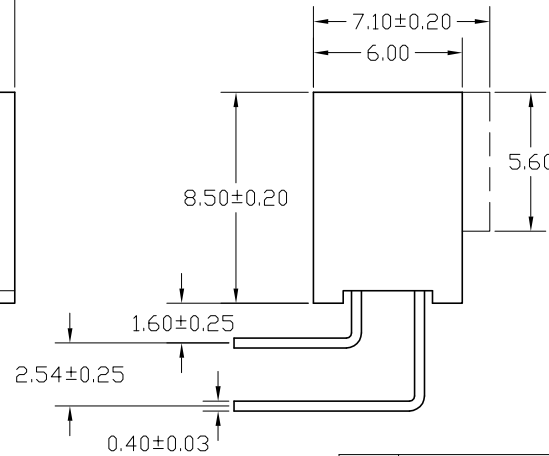
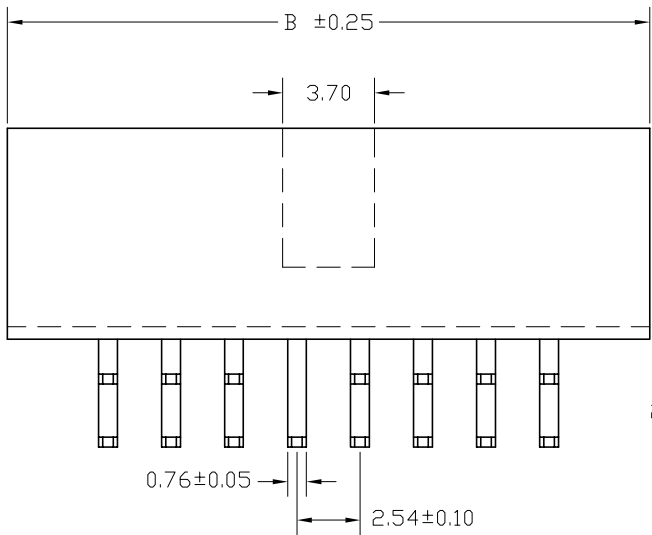
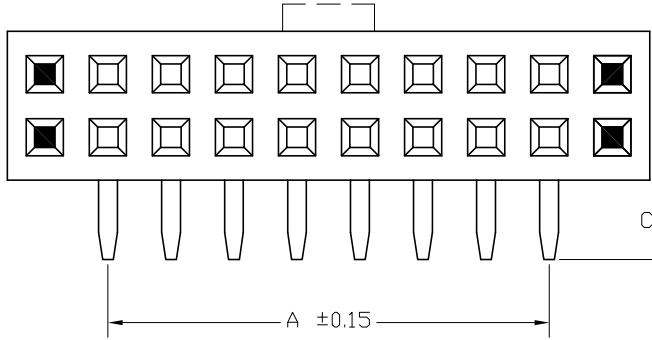

◎ For illustration purpose the BPHFZ-XXR-X-032-X was shown

Recommended PCB Layout (PCB TOLERANCE ±0.05)

Diagram	Molding description
○	mass production & assemble mold
⊙	sample & assemble mold
⊕	mass production & fix mold
⊕	sample & fix mold

Rev.	ECN Number	Description	Drawn	Date
2	EC2-4C0091	修改成共用圖, 修改料號 BPHFZ-XXR-X-032-X->BPHFZ-XXR-X-C-X	洪銀雯	12/04 04'
3	EC2-510434	新增 36PIN	洪銀雯	01/25 05'
4	EC2-520573	新增新增料號選項	陳顯鑫	02/25 05'

PLASTREN
 Plastron Precision Co., Ltd.
 樟翔精密股份有限公司

GENERAL TOLERANCE		SCALE	ORIGINAL DRAWN	DATE
XX. ± 0.50	XXX. ±	4=1	江坤容	06/06 01'
X. ± 0.30	.XXX ±	UNIT	江坤容	02/25 05'
.X ± 0.25	.X* ± 4°	SIZE	林錫錦	02/25 05'
.XX ± 0.20	.X* ± 4°	A4/1.2		

CHECK	APPROVE	DATE
江坤容	林錫錦	02/25 05'

DWG. NO.	TITLE	REV.
3-01	2.54x2.54mm SOCKET	4
PARTS NO. BPHFZ-XXR-X-C-X-*		SHEET 1/1